

FEATURE KEY

- | | |
|--|---|
| 1 EXISTING COW / HORSE ARENA | 16 NEW CLUBHOUSE AND OFFICE |
| 2 EXISTING CLUBHOUSE | 17 NEW INDOOR ARENA (65 x 80m OVERALL) |
| 3 INFORMAL OVERFLOW PARKING | 18 SAND WARM-UP ZONE |
| 4 POWERED CAMPING ZONE (A) 5 x 10m PLOTS - NOM. 80 SITES | 19 FORMAL PARKING ZONE |
| 5 EXIST. AGISTMENT PADDOCKS | 20 EXISTING STABLES AND YARD |
| 6 CAMPING AMENITIES BLOCK | 21 ADDITIONAL STABLE (2019) |
| 7 NEW ENTRY AND ACCESS | 22 NEW STABLES AND PENS |
| 8 UPGRADED ENTRY AND ACCESS | 23 HORSE FLOAT / LOADING ZONE |
| 9 EXISTING POLOCROSSE SHED | 24 ROUND YARD |
| 10 EXISTING POLOCROSSE FIELD | 25 FUTURE STABLE ZONE |
| 11 EXISTING AMENITY BLOCK | 26 EXISTING A.W.E.C. SHED |
| 12 FUTURE PAVILION (20 x 50m CONCRETE PAD) | 27 POWERED CAMPING ZONE (B) 5 x 15m PLOTS - NOM. 36 SITES |
| 13 EXISTING TURF ARENA (80 x 180m APPROX. EXISTING) | 28 EXISTING WATER JUMP |
| 14 DOUBLE DRESSAGE ARENA (60 x 70m SAND ZONE) | 29 EXISTING CROSS-COUNTRY |
| 15 SINGLE DRESSAGE AREA (30 x 70m SAND ZONE) | 30 LOOSE SPECTATOR SEATING |
| | 31 UN-POWERED CAMPING ZONE |

OPTION #3

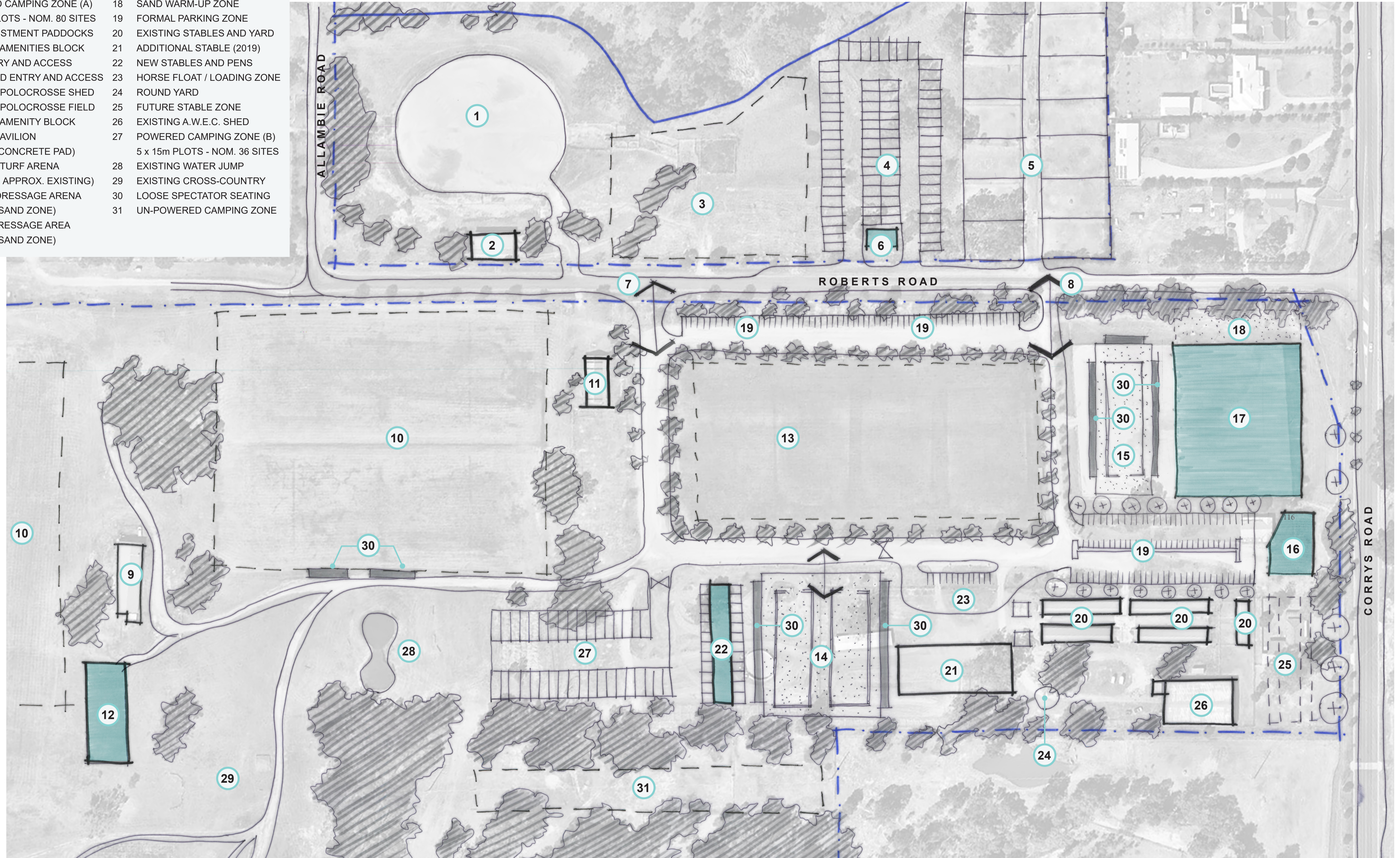

PRELIMINARY FOR DISCUSSION



**ALBURY WODONGA EQUESTRIAN CENTRE
MASTERPLAN**
120 CORRY'S ROAD
THURGOONA, NSW 2640
ALBURY CITY

© Copyright Thomson Adsett (Victoria) Pty Ltd.
ABN 70 105 314 627
Dimensions take precedence over scaling. Do not measure off drawings as print sizes may vary

Telephone +61 3 9685 9100
mel@thomsonadsett.com
Level 1, 333 Queen Street
Melbourne
VIC 3000 Australia
thomsonadsett.com

**thomson
adsett**

SCHEMATIC MASTERPLAN - OPTION 3

1 : 1000 @ A1

16.04.2019

TA # 19.0134.13

SK03

rev. A