

FEATURE KEY

- | | | | |
|----|---|----|---|
| 1 | EXISTING COW / HORSE ARENA | 16 | NEW INDOOR ARENA
(60 x 80m OVERALL) |
| 2 | EXISTING CLUBHOUSE | 17 | SAND WARM-UP ZONE |
| 3 | INFORMAL OVERFLOW PARKING | 18 | POWERED CAMPING ZONE (B)
5 x 10m PLOTS - NOM. 15 SITES |
| 4 | POWERED CAMPING ZONE (A)
5 x 10m PLOTS - NOM. 80 SITES | 19 | FORMAL PARKING ZONE |
| 5 | EXIST. AGISTMENT PADDOCKS | 20 | EXISTING STABLES AND YARD |
| 6 | CAMPING AMENITIES BLOCK | 21 | ADDITIONAL STABLE (2019) |
| 7 | NEW ENTRY AND ACCESS | 22 | NEW STABLES AND PENS |
| 8 | UPGRADED ENTRY AND ACCESS | 23 | HORSE FLOAT / LOADING ZONE |
| 9 | EXISTING POLOCROSSE SHED | 24 | ROUND YARD |
| 10 | EXISTING POLOCROSSE FIELD | 25 | FUTURE STABLE ZONE |
| 11 | EXISTING AMENITY BLOCK | 26 | EXISTING A.W.E.C. SHED |
| 12 | FUTURE PAVILION
(20 x 50m CONCRETE PAD) | 27 | POWERED CAMPING ZONE (C)
5 x 15m PLOTS - NOM. 36 SITES |
| 13 | MODIFIED TURF ARENA
(80 x 100m MINIMUM CLEAR) | 28 | EXISTING WATER JUMP |
| 14 | DOUBLE DRESSAGE ARENA
(60 x 70m SAND ZONE) | 29 | EXISTING CROSS-COUNTRY |
| 15 | NEW CLUBHOUSE AND OFFICE | 30 | LOOSE SPECTATOR SEATING |
| | | 31 | UN-POWERED CAMPING ZONE |

OPTION #1

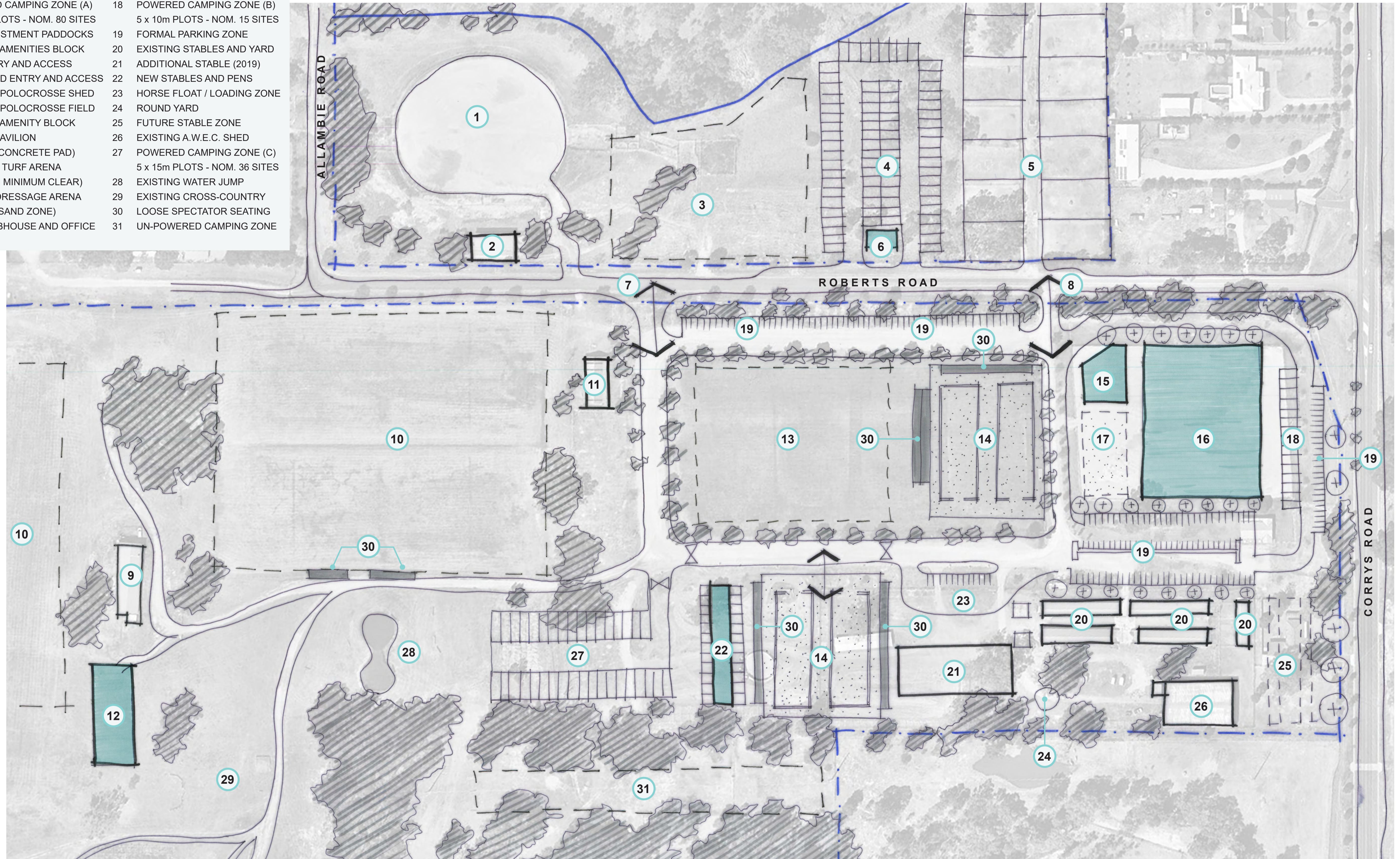

PRELIMINARY FOR DISCUSSION

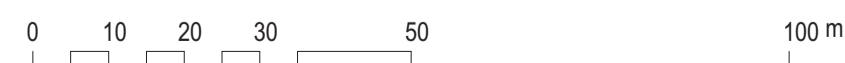

**ALBURY WODONGA EQUESTRIAN CENTRE
MASTERPLAN**
120 CORRY'S ROAD
THURGOONA, NSW 2640
ALBURY CITY

© Copyright Thomson Adsett (Victoria) Pty Ltd.
ABN 70 105 314 627
Dimensions take precedence over scaling. Do not measure off drawings as print sizes may vary

Telephone +61 3 9685 9100
mel@thomsonadsett.com
Level 1, 333 Queen Street
Melbourne
VIC 3000 Australia
thomsonadsett.com

**thomson
adsett**

SCHEMATIC MASTERPLAN - OPTION 1

1 : 1000 @ A1

16.04.2019

TA # 19.0134.13

SK01

rev. B